



first evangelical
free church
OF COLORADO SPRINGS

PROPERTY INFORMATION

for our new location at West Fillmore Street and Mesa Road



In 2016, First Evangelical Free Church of Colorado Springs purchased 15.2 acres at the intersection of West Fillmore Street and Mesa Road. Currently meeting at North 30th and Fontanero, we hope the new property will allow for growth and greater positive involvement in the community. We are thankful to God for this opportunity to continue serving the West Side of Colorado Springs at our new location for years to come.

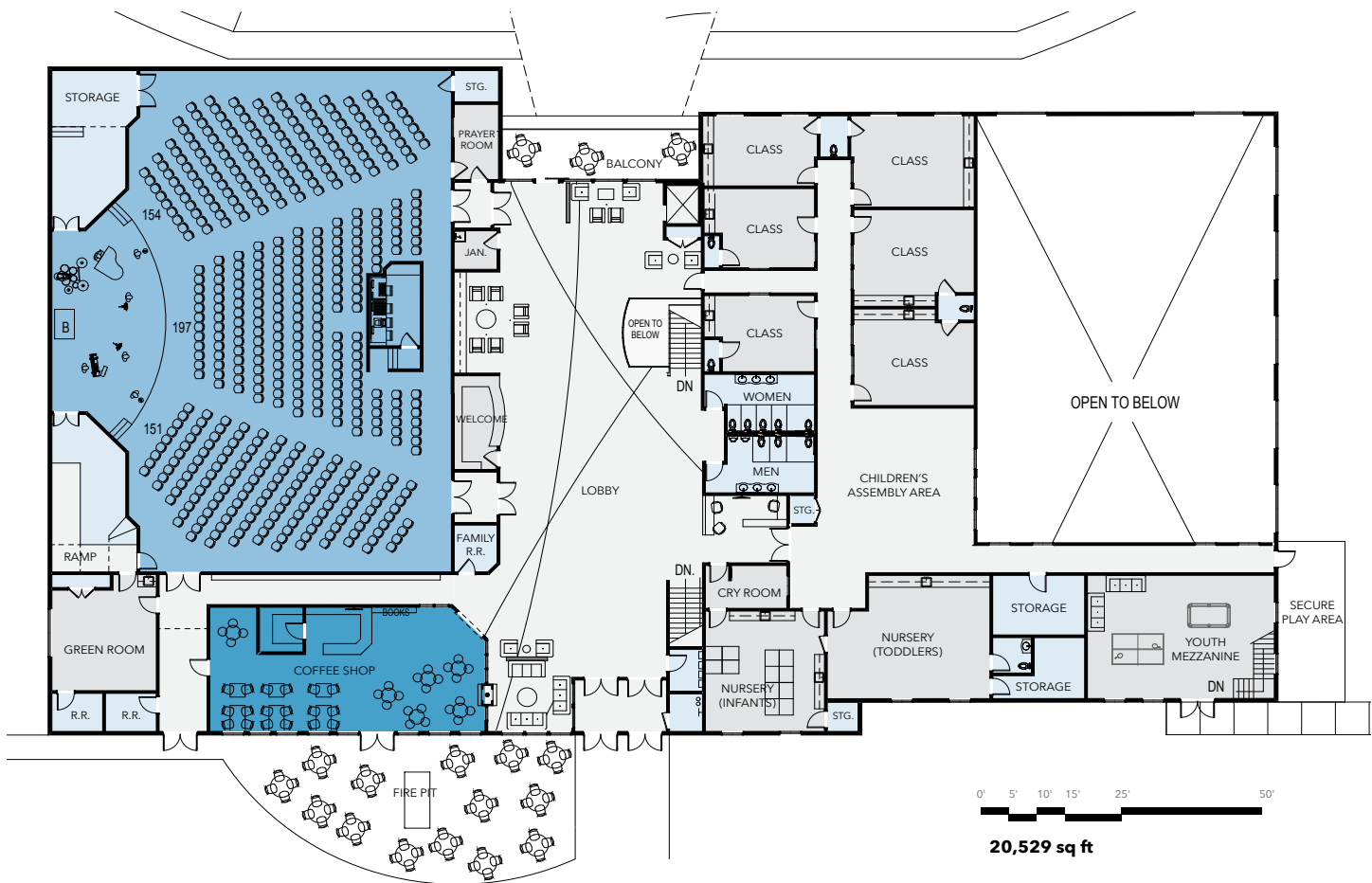

BY THE NUMBERS

Property	15.2 acres
Building	45,271 square feet
Sanctuary	500 seats
Parking	300 spaces
Children	6 classrooms
Youth	5 classrooms
Adult	5 classrooms
Nursery	12 cribs + toddler room
Coffee Shop	40 seats + patio
Fellowship Hall	300 seats
Office Space	8 offices + team areas
Meeting Space	2 rooms
Adult Restrooms	10 locations
Kids Restrooms	5 locations
Hiking Trail Area	7 acres

UPPER FLOOR

HIGHLIGHTS

WORSHIP CENTER Our church sanctuary is designed to seat 500 people in a room whose environment can be controlled using the latest technology advances.

LOBBY AND COFFEE SHOP The lobby is our welcoming information hub. It includes generous conversation areas, a welcome center, balcony and a coffee shop. Designed to be a multi-use social gathering place throughout the week, the coffee shop offers an outdoor patio with a fire pit and views of Pikes Peak.

KIDS AREA The children's area and nursery include convenient parental drop-off and pickup, security features, large classrooms, a group assembly area and easy access to a secure outdoor play space. Toddlers and infants will have separate areas designed for their needs.



24,742 sq ft

LOWER FLOOR

HIGHLIGHTS

KITCHEN AND EVENT SPACE Our facility will have a large fellowship room with seating for 300 people, served by a fully equipped kitchen, a program stage, and storage for tables and chairs. There is a spacious outdoor patio for taking advantage of Colorado's 300 days of sunshine each year and enjoying outdoor programs in an amphitheater-like setting.

GYMNASIUM Our new gymnasium will be a large multi-purpose area for sports and other gatherings. It will have its own secure access so that it can be used during the week without opening the entire building.

YOUTH SPACE The building plan has great spaces designed for middle and high school students, including classrooms, breakout rooms, and a mezzanine game room.

The new church facility is designed to accommodate our future growth, increasing our usable space from 20,000 square feet at our current property to over 45,000 square feet in the new facility.



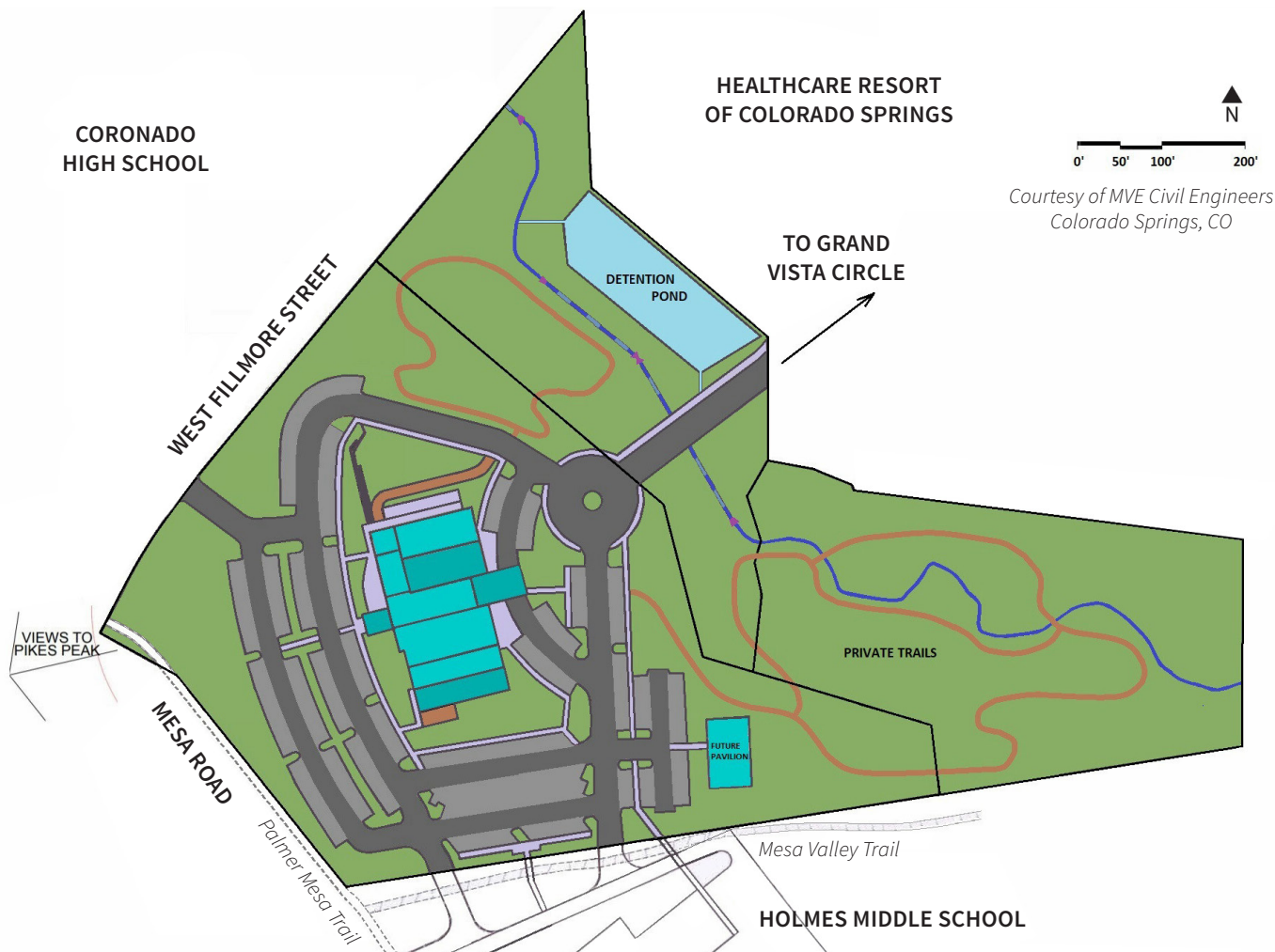

SITE FEATURES

LOCATION The Interstate is just one and a half miles to the east, with convenient access to King Soopers and the VA Clinic. Close neighbors include Holmes Middle School, Coronado High School, and The HealthCare Resort.

CURB APPEAL This development, with professional landscaping, generous lighting, and an attractive exterior, will enhance the “Colorado Look” of our neighborhood.

VEHICULAR ACCESS The property will have ample parking with vehicular access to West Fillmore Street, Grand Vista Circle, and Mesa Road.

OUTDOOR AMENITIES Future plans for the property include a pavilion and a network of walking trails through the valley.

For more information about the church’s relocation plans, please contact:

Becky Johnson | Community Relations Coordinator
phone **719-351-7066** | email **180reversal@gmail.com**

To inquire about our ministry, or to contribute to the Relocation Fund, please contact:

First Evangelical Free Church Office
phone **719-634-3144** | email **office@1freechurch.org**
website **1freechurch.org**

We are honored to work with the following professional team:

Architect : Don Mahoney, Principle Architect & President, Building God’s Way, Ogden, UT
Civil Engineer: Charles Crum, P.E. and David Gorman, P.E., M.V.E., Inc., Colorado Springs, CO
General Contractor: Wayne DeCosta and Bob Dudley, Great West Construction, Colorado Springs, CO